

NOTES:

1. THIS SURVEY WAS PREPARED BY BATEMAN CIVIL SURVEY CO., UNDER THE SUPERVISION OF JEFFREY W. BAKER, PLS.
2. THIS PLAN HAS BEEN PREPARED FOR LAYOUT AND PERMITTING PURPOSES ONLY.
3. THIS IS NOT A BOUNDARY SURVEY. PROPERTY LINES SHOWN WERE TAKEN FROM EXISTING FIELD EVIDENCE, EXISTING DEEDS AND PLATS OF PUBLIC RECORD, AND INFORMATION SUPPLIED TO THE SURVEYOR BY THE CLIENT.
4. VERTICAL DATUM IS ASSUMED. THE LATITUDE, LONGITUDE AND STATE PLANE COORDINATES, IF SHOWN, ARE GIVEN IN NORTH AMERICAN DATUM OF 1983 (NAD83/2007).
5. FIELD EQUIPMENT USED: TRIMBLE, EPOCH 35.
6. ALL DISTANCES ARE HORIZONTAL GROUND DISTANCES AND ALL BEARINGS ARE NORTH CAROLINA STATE PLANE COORDINATE SYSTEM UNLESS OTHERWISE SHOWN.
7. THIS MAP IS NOT A CERTIFIED SURVEY AND HAS NOT BEEN REVIEWED BY A LOCAL GOVERNMENT AGENCY FOR COMPLIANCE WITH ANY APPLICABLE LAND DEVELOPMENT REGULATIONS.
8. THE PROPERTY LIES IN ZONES "X" PER NATIONAL FLOOD INSURANCE PROGRAM FLOOD INSURANCE RATE MAP COMMUNITY NUMBER 3710986400K, DATED November 17, 2017.
9. ZONING IS MFSU.
10. PROPERTY OWNER: BRADDOCK PARK ASSOCIATES INC. PO BOX 1389, HILLSBOROUGH, NC 27278

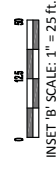
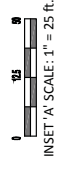
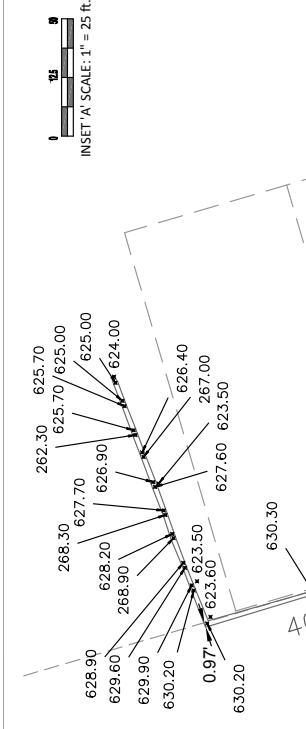

I hereby certify that this map is correct and that the building and wholly on the lot and that there are no visible encroachments on said lot except as shown.

PRELIMINARY

Jeffrey W. Baker, PLS 4412 Date

This map is of an existing parcel of land and is only intended for the parties and purposes shown. This map not for recordation. No title report provided.

Bateman Civil Survey Company
 Engineers • Surveyors • Planners
 2524 Reliance Ave., Apex, NC 27539
 Phone: 919.577.1080 Fax: 919.577.1081
 NCBELS FIRM No. C-2378

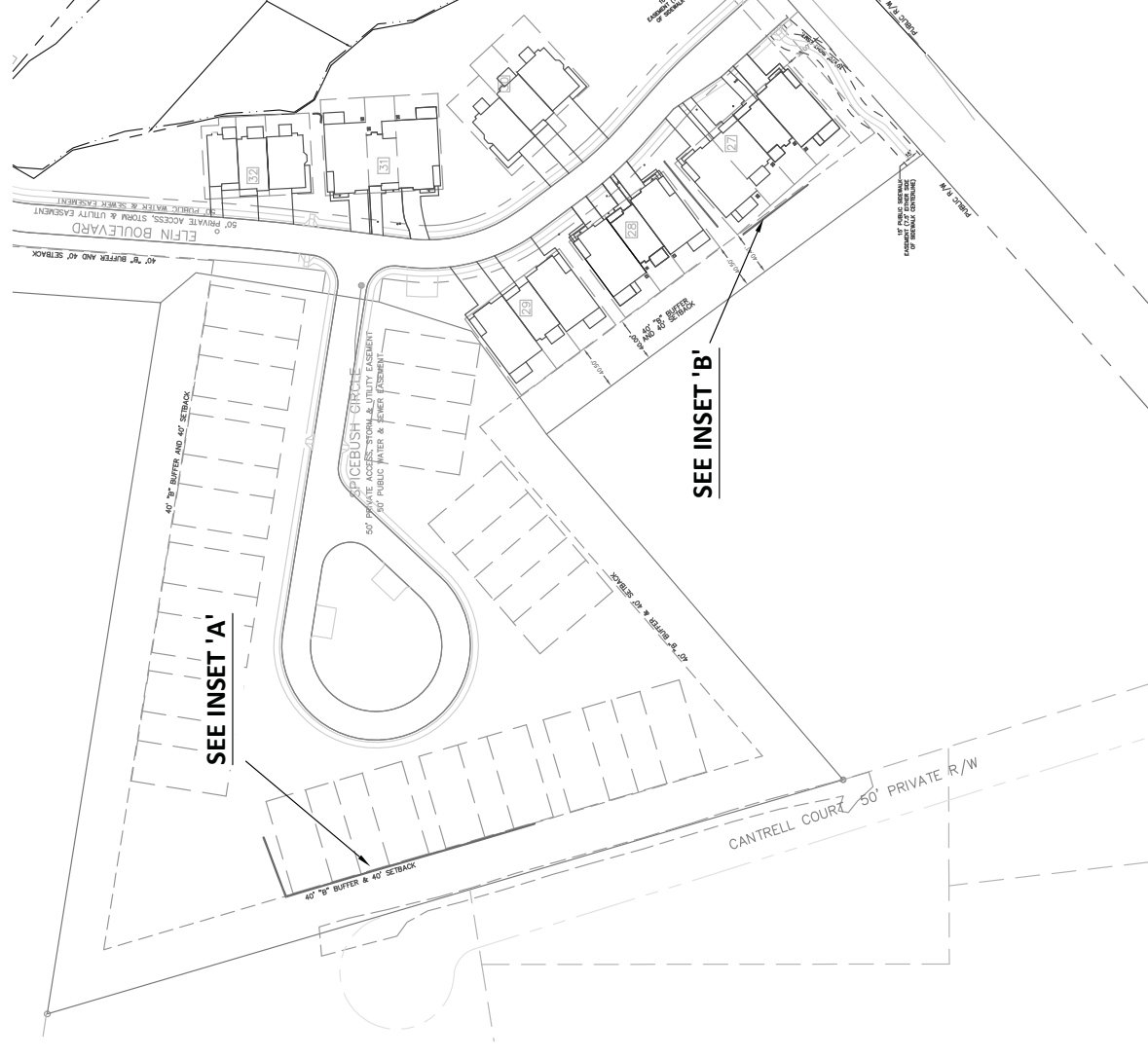

RETAINING WALL AS-BUILT EXHIBIT
 ELFIN POND, PHASE 2
 HILLSBOROUGH, NC, ORANGE COUNTY
 REF: PB 117, PG 165

BRADDOCK PARK ASSOCIATES INC.
 PO BOX 1389
 HILLSBOROUGH, NC, 27278

Designed By: N/A
 Drawn By: JCH
 Checked By: JWB
 Scale: 1"=100'
 Date: 05/25/2018
 Project #: 140319

REFERENCES

- PLAT BOOK 117 PAGE 165
- DEED BOOK 6074 PAGE 473



AS-BUILT
 1 OF 1